

**PLAN D - LOWER FLOOR PLAN**  
410 SQ FT

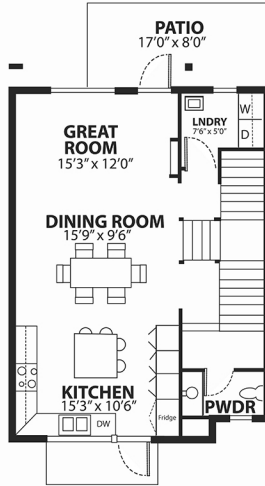

**PLAN D - MAIN FLOOR PLAN**  
795 SQ FT

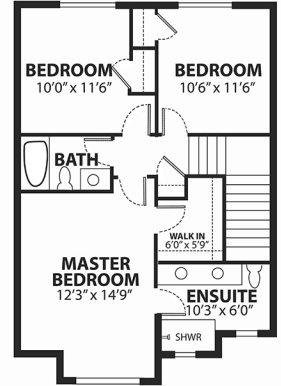

**PLAN D - UPPER FLOOR PLAN**  
750 SQ FT



**PLAN D | 1,955 SQUARE FEET | 3 BEDROOMS, REC ROOM, 2.5 BATH, 2 CAR GARAGE**

IN A CONTINUED EFFORT TO IMPROVE THE HOMES, THE DEVELOPER RESERVES THE RIGHT TO MODIFY OR CHANGE PLANS AND SPECIFICATIONS WITHOUT NOTICE. WITHIN THIS COMMUNITY, FLOORPLANS MAY BE REVERSED BASED UPON LOCATION. ALL DIMENSIONS AND SIZE ARE APPROXIMATE. RENDERINGS ARE AN ARTIST'S CONCEPTION AND ARE INTENDED AS A GENERAL REFERENCE ONLY. SELLER RESERVES THE RIGHT TO CHANGE PRODUCT OFFERINGS, SPECIAL INCENTIVES OR PRICING WITHOUT NOTICE. BUYERS ARE RECOMMENDED TO READ THE SALES DISCLOSURE STATEMENT AND REVIEW THE ARCHITECTURAL PLANS PRIOR TO PURCHASE. E&OE.